

# PROPOSED RESIDENTIAL BUILDING " PUSHP BHARTI CITY "

## AT - BY-PASS , PATNA

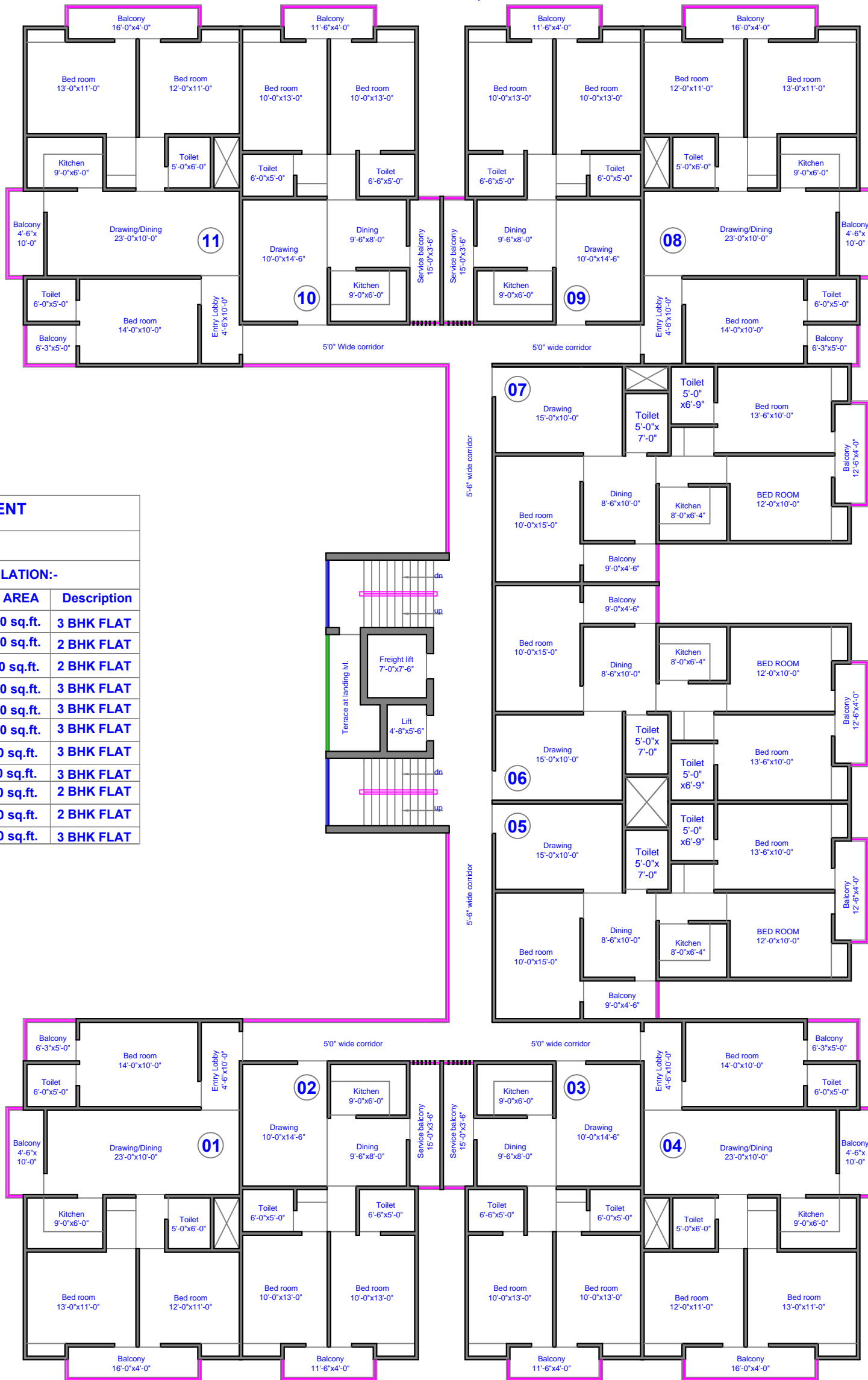

AREA STATEMENT		
BLOCK - C & F		
FLAT AREA CALCULATION:-		
FLAT NO.	S/B/U. AREA	Description
01	1350.00 sq.ft.	3 BHK FLAT
02	1020.00 sq.ft.	2 BHK FLAT
03	1020.00 sq.ft.	2 BHK FLAT
04	1350.00 sq.ft.	3 BHK FLAT
05	1250.00 sq.ft.	3 BHK FLAT
06	1250.00 sq.ft.	3 BHK FLAT
07	1250.00 sq.ft.	3 BHK FLAT
08	1350.00 sq.ft.	3 BHK FLAT
09	1020.00 sq.ft.	2 BHK FLAT
10	1020.00 sq.ft.	2 BHK FLAT
11	1350.00 sq.ft.	3 BHK FLAT

**BLOCK : A,D,E,F,G & J**

**TYPICAL ( 1ST TO 8TH ) FLOOR PLAN**

PROJECT :

**Proposed residential building " PUSHP BHARTI CITY "**  
at - By-pass, Patna

DEVELOPER :

**PUSHP BHARTI PVT.LTD**

NORTH

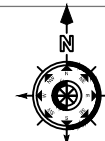

**Aryan architects**

ARCHITECTS , INTERIOR & LANDSCAPE DESIGNERS  
H.O. - Pahalawan mkt., Hartali more, Patna  
B.O. - Jyotipuram colony, Jagdeo path, Patna.  
MO. : 9 6 9 3 6 1 5 5 6 6 , 9 3 3 4 9 9 9 2 6 2  
ARCHITECT - UMASHANKAR KUMAR  
Email : umashankar\_architect@rediffmail.com

www.aryanarchitects.com